



## FEATURES

Compact Design for use in a Van or Truck  
12V/24V DC by Battery Power  
Up to 1 1/4" SP hydraulic hose

## OPTIONS

12V/24V DC

# P20DC

## TECHNICAL DATA

Max crimping dia (mm/inch) <sup>1)</sup>	87/3.42
Max crimping dia with master dies (mm/inch)	109/4.3
Max crimping force (KN)	1600
Max crimping force (tonnage)	160
Cycle time 10 mm (s) <sup>2)3)</sup>	4
Hydraulic hose size (inch)	1 1/2 *
Industrial hose size (inch)	2.40 *
Die set series	32
Max opening (mm) <sup>4)</sup>	+25
Max opening without dies (mm)	124
Master die D/L (mm)	99/80
Master die D/L (inch)	3.90/3.15
Motor Power (kW/HP) <sup>3)</sup>	3.0/4.0 1.5/2.0 (12/24V DC)
Oil tank volume	25 L

## DIMENSIONS (LxWxH)

Machine (mm)	820x700x650
Machine (inch)	32.3x27.6x25.6
Packaged (mm)	920x800x800
Packaged (inch)	36.2x31.5x31.5

## WEIGHT

Machine (kg/lbs)	220/485
Packaged (kg/lbs)	240/529

\* ACCORDING TO THE FITTING.

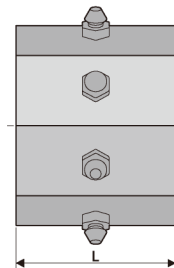
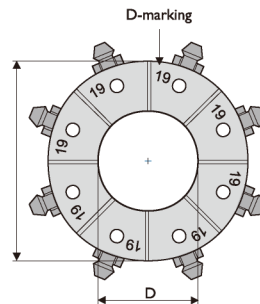

- 1) Maximum opening is the total die travel. Add this value to the minimum crimping diameter of the die set used. The result is the maximum opening of the machine with die set in place.
- 2) 3-phase/1-phase

## CONTROL

Micro Control

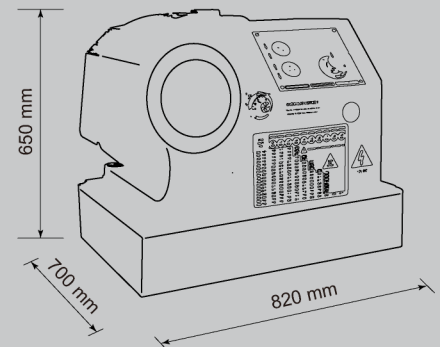

## DIE SET 20-SERIES

DieSetNo	D (mm)	L (mm)	Crimp. range (mm)
*18506/10	10	60	10.0-12.0
*18506/12	12	60	12.0-14.0
18506/14	14	60	14.0-16.0
18506/16	16	60	16.0-19.0
18506/19	19	60	19.0-22.0
18506/22	22	75	22.0-26.0
18506/26	26	75	26.0-30.0
18506/30	30	75	30.0-34.0
18506/34	34	80	34.0-39.0
18506/39	39	80	39.0-45.0
18506/45	45	90	45.0-51.0
*18506/51	51	90	51.0-57.0
*18506/57	57	100	57.0-63.0
*18506/63	63	100	63.0-69.0
*18506/69	69	100	69.0-75.0
*18506/74	74	110	74.0-80.0
*18506/78	78	110	78.0-87.0

\* Optional die sets at additional cost

Products images & Specifications may alter prior official notice at any time.